

TUERCA TENSILOCK BICROMATADA

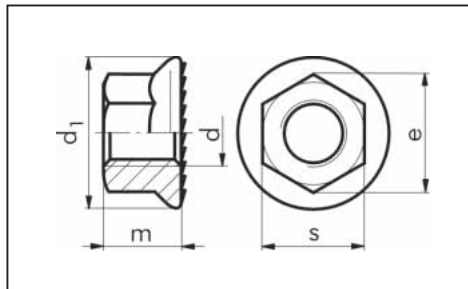

ORSY



Similar a DIN 6923

(con arandela dentada)
Acero calidad 8
bicromatado

métrica	s	e	m	d ₁	Art. No.	Art. No.	U/E
d	mm	mm	mm	mm			
M 4	7	7.66	4	10.41	0394 4	0394 04 *	100
M 5	8	8.79	5	11.8	0394 5	0394 05 *	
M 6	10	11.05	6	14.2	0394 6	0394 06 *	
M 8	13	14.38	8	17.9	0394 8	0394 08 *	
M 10	15	16.64	10	21.8	0394 10	0394 010 *	
M 12	18	20.03	12	26	0394 12	0394 012 *	
M 16	24	26.75	16	34.5	0394 16 *	0394 016 *	

* Pedido especial

TUERCA DE SOMBRETE ALTA

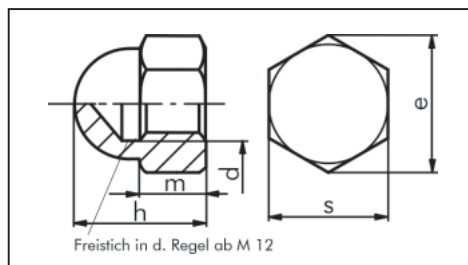

Freistich in d. Regel ab M 12

(Forma Alta) DIN 1587

Thread	e	h	y	s	Acero cincado Art. No.	U/E	Acero Galv. Art. No.	Qty.	Latón desnudo Art. No.	Latón Art. No.	Latón niquelado Art. No.	A2 ^{rust proof} Art. No.	P.	A4 ^{rust proof} Art. No.	P.					
d	mm	mm	mm	mm																
M 3	6.01	7.0	2.4	5.5	0356 3 *	100	0356 61 *	100	0350 3 *	0352 43 *	0352 3 *	0348 4	100	0349 4 *	100					
M 4	7.66	8.0	3.2	7	0356 4 *				0350 4 *	0352 44 *	0352 4 *			0348 5 *		0349 5 *				
M 5	8.79	10.0	4.0	8	0356 5 *				0350 5 *	0352 45 *	0352 5 *			0348 6		0349 6 *				
M 6	11.05	12.0	5.0	10	0356 6 *				0350 6 *	0352 46 *	0352 6 *			0348 8		0349 8 *				
M 8	14.38	15.0	6.5	13	0356 8 *				0350 8 *	0352 48 *	0352 8 *			0348 10		0349 10 *				
M 10	18.90	18.0	8.0	17	0356 10 *				0350 10 *	25	0352 410 *			50		0352 10 *	0348 12 *	50	0349 12 *	50
M10x1.25	18.90	18.0	8.0	14	0356 10 125 *															
M 12	21.10	22.0	10.0	19	0356 12 *			0350 12 *	25		0352 12 *	50	0348 12 *	50	0349 12 *	50				
M12x1.5	21.10	22.0	10.0	19	0356 12 15 *	100														
M 14	24.49	25.0	11.0	22	0356 14 *	50		0350 14 *	100		0352 14 *	50	0348 14 *	100	0349 14 *	100				
M 16	26.75	28.0	13.0	24	0356 16 *	25		0350 16 *	25		0352 16 *	25	0348 16 *	50	0349 16 *	50				
M 20	33.53	34.0	16.0	30	0356 20 *			0350 20 *	5											
M 24	39.98	42.0	19.0	36	0356 24 *	5/25									0349 24 *	50				

* Pedido especial